

1200'
07/03/2002

T.4N., & T.5N., R.9E., M.D.B.&M.

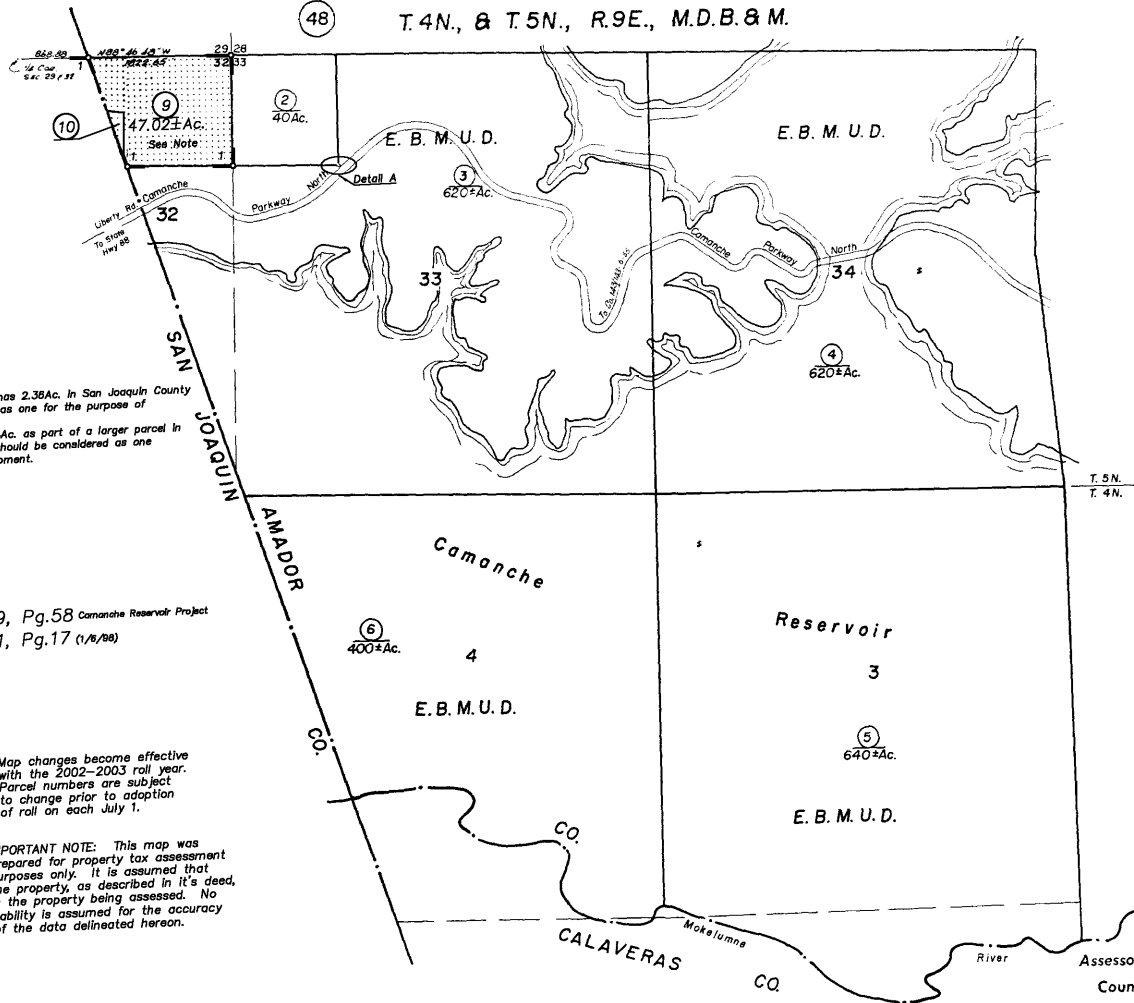

NOTE: 03-470-009-00 has 2.38Ac. in San Joaquin County and should be considered as one for the purpose of development.
03-470-010-00 has 2.34Ac. as part of a larger parcel in San Joaquin County and should be considered as one for the purpose of development.

R.M.Bk. 9, Pg.58 Camanche Reservoir Project
1-R.M.Bk.51, Pg.17 (1/8/88)

Map changes become effective with the 2002-2003 roll year. Parcel numbers are subject to change prior to adoption of roll on each July 1.

IMPORTANT NOTE: This map was prepared for property tax assessment purposes only. It is assumed that the property, as described in it's deed, is the property being assessed. No liability is assumed for the accuracy of the data delineated hereon.

8 Camanche Reservoir land above flow line. 3377.78±Ac.

7 Camanche Reservoir land below flow line. 3313.78±Ac.