

**POR. NW 1/4 SEC. 30, T. 6N., R. 10E., M. D. B. & M.
& POR. RANCHO ARROYO SECO**

Tax Area Code
5-002

4-26

NOTE: This Map Was Prepared For Assessment Purposes Only. No Liability Is Assumed For The Accuracy Of The Data Delineated Hereon.

Map changes become effective with the 96-97 roll year. Parcel numbers are subject to change prior to adoption of roll on each July 1.

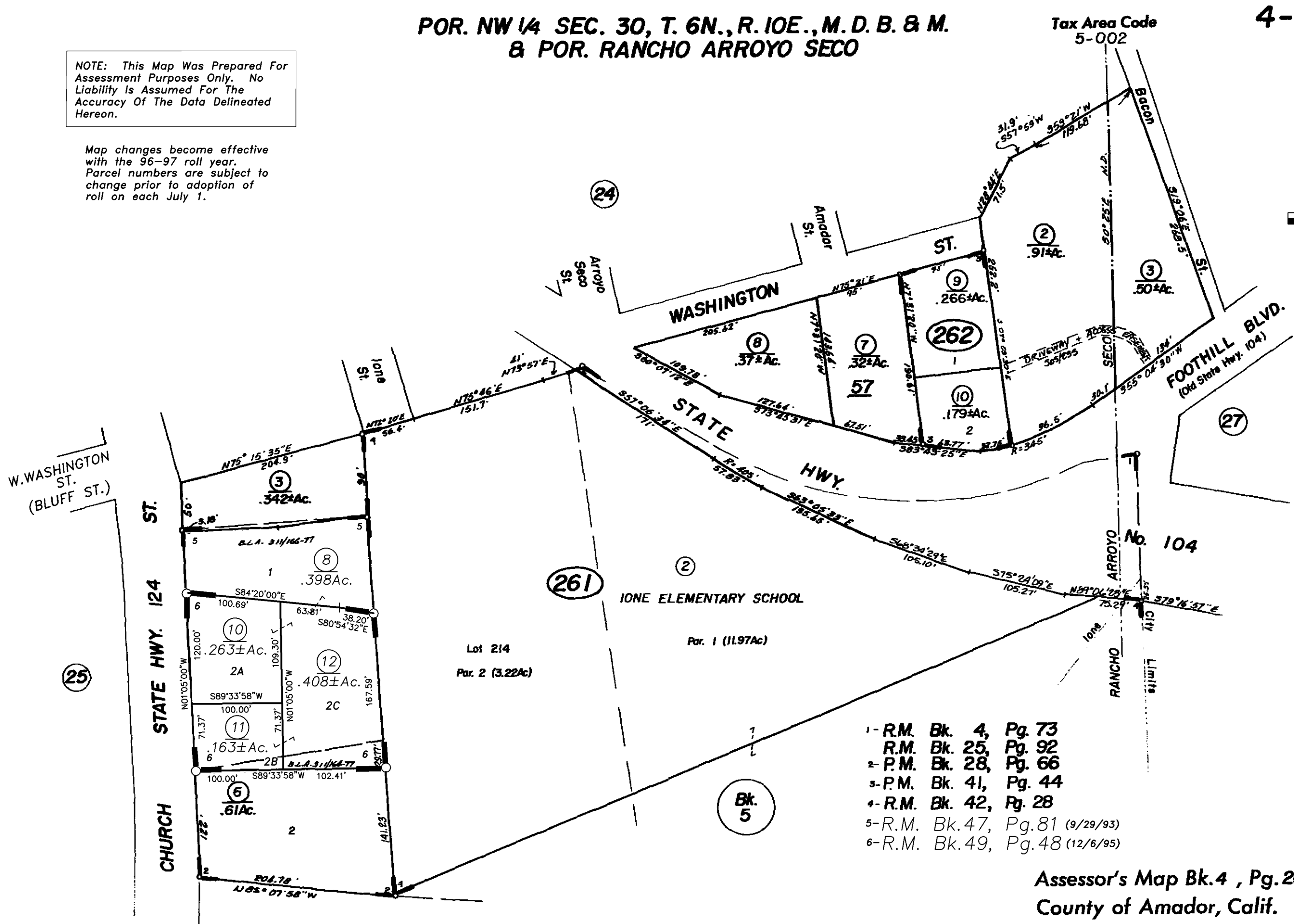
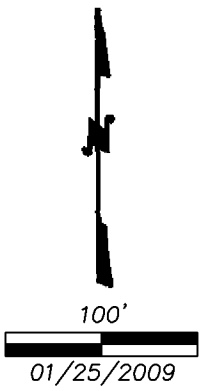

- 1- R.M. Bk. 4, Pg. 73
- 2- R.M. Bk. 25, Pg. 92
- 3- P.M. Bk. 28, Pg. 66
- 4- P.M. Bk. 41, Pg. 44
- 5- R.M. Bk. 42, Pg. 28
- 6- R.M. Bk. 47, Pg. 81 (9/29/93)
- 7- R.M. Bk. 49, Pg. 48 (12/6/95)

**Assessor's Map Bk. 4 , Pg. 26
County of Amador, Calif.**

NOTE—Assessor's Block Numbers Shown in Ellipses.
Assessor's Parcel Numbers Shown in Circles.