

POR. SEC. 6 & 7, T.6N., R.11E., M. D. B. & M.

18-06

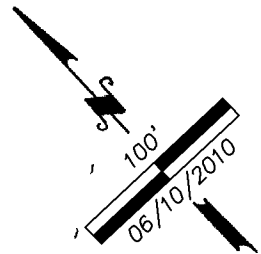
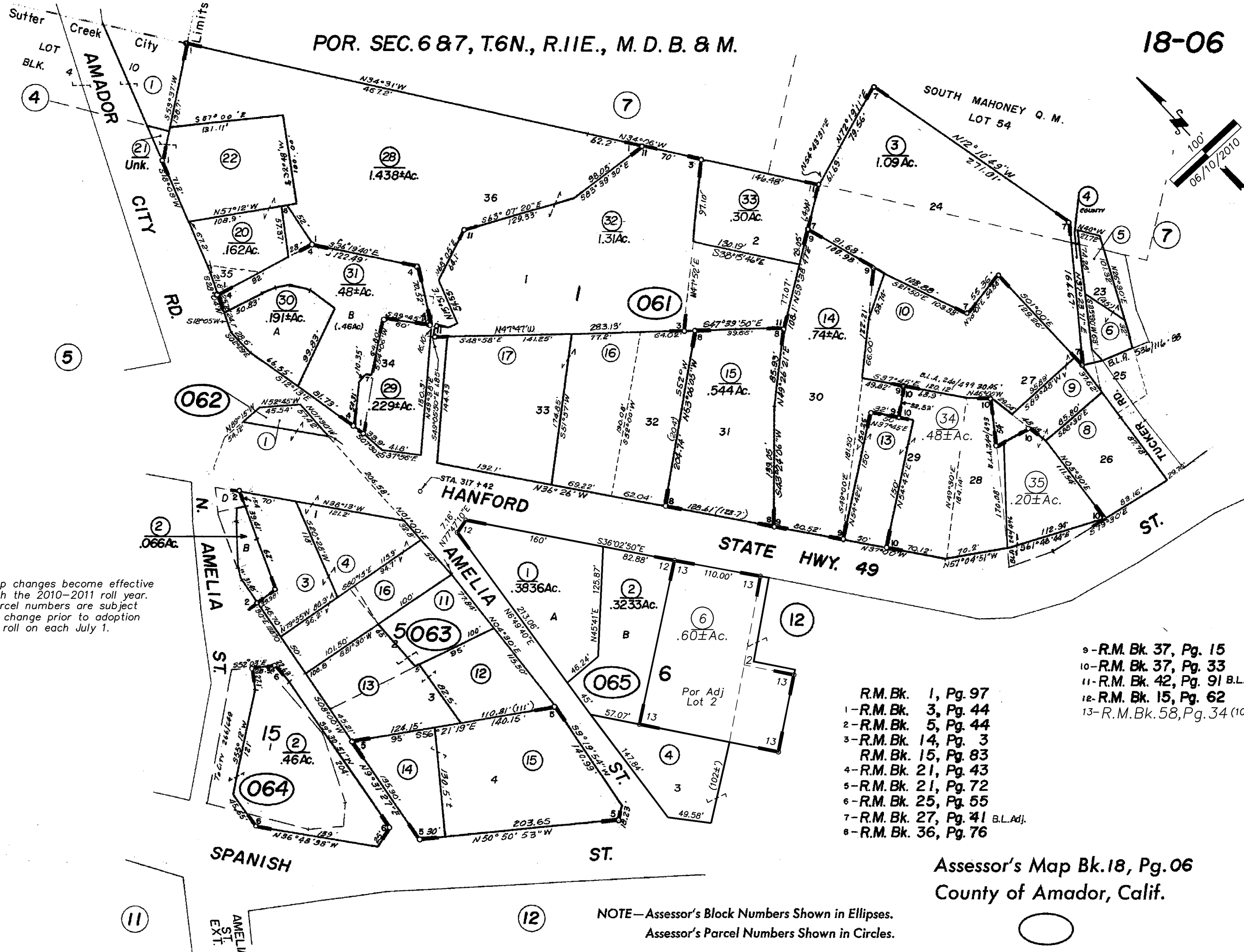

Map changes become effective with the 2010-2011 roll year. Parcel numbers are subject to change prior to adoption of roll on each July 1.

- 9-R.M. Bk. 37, Pg. 15
- 10-R.M. Bk. 37, Pg. 33
- 11-R.M. Bk. 42, Pg. 91 B.L. Adj. (7/27/88)
- 12-R.M. Bk. 15, Pg. 62
- 13-R.M. Bk. 58, Pg. 34 (10/27/2005)

- R.M. Bk. 1, Pg. 97
- 1-R.M. Bk. 3, Pg. 44
- 2-R.M. Bk. 5, Pg. 44
- 3-R.M. Bk. 14, Pg. 3
- R.M. Bk. 15, Pg. 83
- 4-R.M. Bk. 21, Pg. 43
- 5-R.M. Bk. 21, Pg. 72
- 6-R.M. Bk. 25, Pg. 55
- 7-R.M. Bk. 27, Pg. 41 B.L. Adj.
- 8-R.M. Bk. 36, Pg. 76

Assessor's Map Bk. 18, Pg. 06
County of Amador, Calif.

NOTE— Assessor's Block Numbers Shown in Ellipses.
Assessor's Parcel Numbers Shown in Circles.

