

POR. SECS 21 & 22, T.7N., R.13E., M.D.B. & M.

Tax Area Code
52-010

33-14

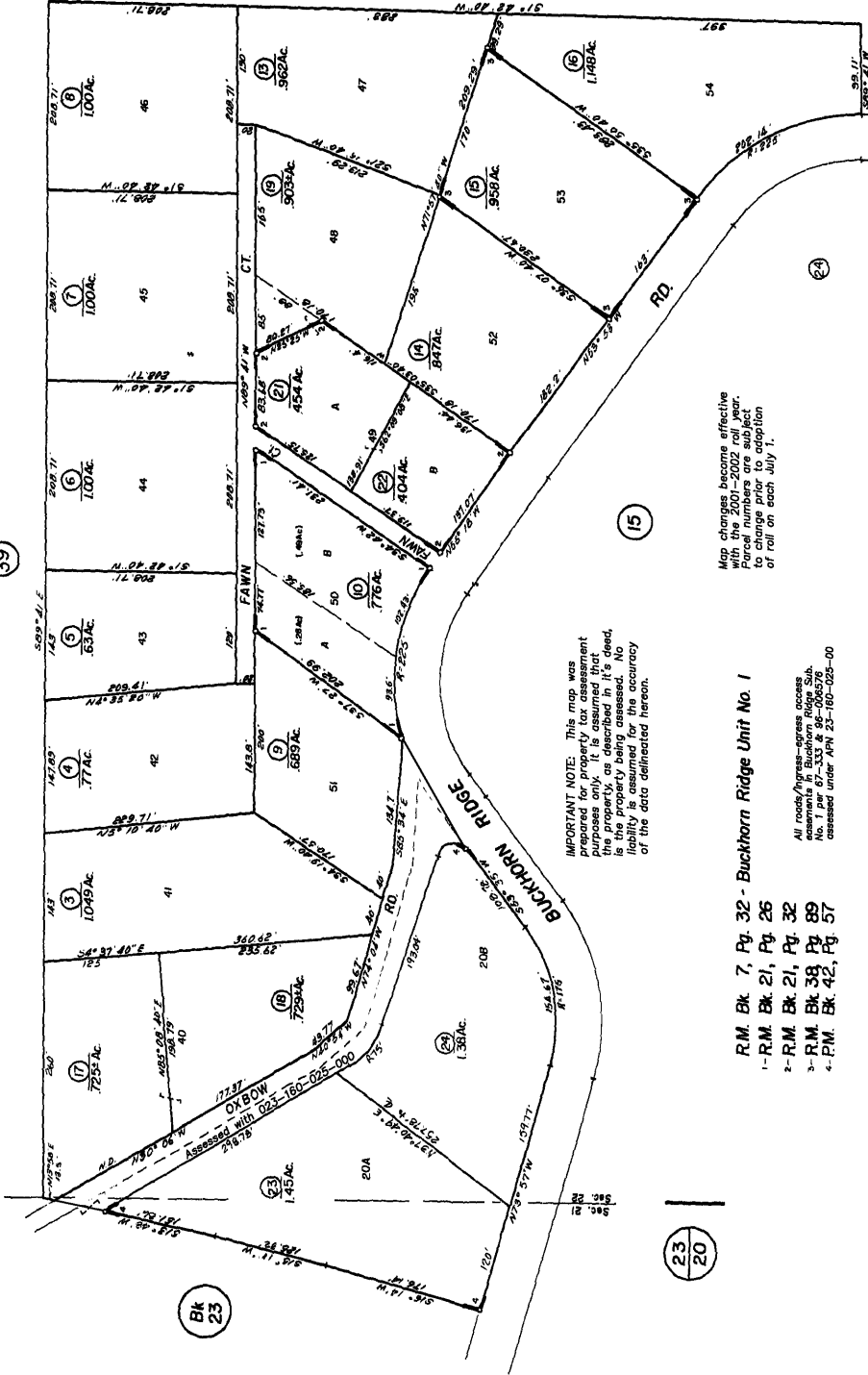
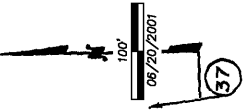

IMPORTANT NOTE: This map was prepared for present purposes only. It is assumed that the property as described in it's deed, is the property being assessed. No liability is assumed for the accuracy of the data delineated hereon.

Map changes become effective with the 2001-2002 tax year. Parcel numbers are subject to change prior to adoption of roll on each July 1.

R.M. Bk 7, Pg. 32 - Buckhorn Ridge Unit No. 1

- 1- R.M. Bk 21, Pg. 26
 - 2- R.M. Bk 21, Pg. 32
 - 3- R.M. Bk 38, Pg. 89
 - 4- P.M. Bk 42, Pg. 57
- All roads/paths-access easements in Buckhorn Ridge Sub. No. 1 per 67-333 & 89-006578 assessed under APN 25-160-025-00

NOTE—Assessor's Block Numbers Shown in Ellipses. Assessor's Parcel Numbers Shown in Circles.

Assessor's Map Bk. 55, Pg. 14
County of Amador, Calif.