

POR. SEC.'S 29 & 30, T. 6N., R10E., M.D.B.&M.

TAX AREA CODE  
005-015

11-38

WILDFLOWER UNIT 2

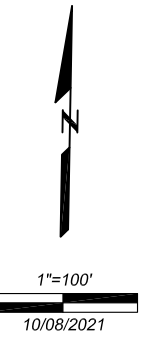

IMPORTANT NOTE: This map was prepared for property tax assessment purposes only. It is assumed that the property, as described in its deed, is the property being assessed. No liability is assumed for the accuracy of the data delineated hereon.

R.M. Bk.10, Sub. Pg.41 (12/10/2021) Wildflower Unit 2

NOTE—Assessor's Block Numbers Shown in Ellipses.  
Assessor's Parcel Numbers Shown in Circles.