

Requested By:  
**BOARD OF SUPERVISORS**  
When Recorded Return To:  
**SURVEYING & ENGINEERING**

---

**BEFORE THE BOARD OF SUPERVISORS OF THE  
COUNTY OF AMADOR, STATE OF CALIFORNIA**

IN THE MATTER OF

RESOLUTION ISSUING CERTIFICATES ) RESOLUTION NO. 15-113  
OF COMPLIANCE TO DAVID B. GILMORE )  
JILL R. GILMORE AND GERALD E. SMITH )

BE IT RESOLVED by the Board of Supervisors of the County of Amador, State of California, pursuant to Government Code 66499.34 and 66499.35 that said Board does hereby approve the issuance of two (2) certificates of compliance for David B. Gilmore, Jill R. Gilmore and Gerald E. Smith for the parcel described in Exhibits "A" of the certificates of compliance, which certificates, along with said Exhibits "A", is attached thereto and incorporated therein by reference as though set forth in full; and

BE IT FURTHER RESOLVED that the Clerk of said Board be and hereby is directed to record this resolution and said certificates of compliance with Exhibits "A".

The foregoing resolution was duly passed and adopted by the Board of Supervisors of the County of Amador at a regular meeting thereof, held on the 24th day of November, 2015, by the following vote:

AYES: Brian Oneto, John Plasse, Louis D. Boitano, Richard M. Forster, and  
Lynn A. Morgan

NOES: None

ABSENT: None

  
\_\_\_\_\_  
Brian Oneto, Chairman, Board of Supervisors

ATTEST:

JENNIFER BURNS, Clerk of the  
Board of Supervisors, Amador County,  
California

  
\_\_\_\_\_  
Deputy

Recording requested by:  
**BOARD OF SUPERVISORS**  
When recorded send to:  
**SURVEYING & ENGINEERING**

---

**CERTIFICATE OF COMPLIANCE**  
**FOR DAVID B. GILMORE, JILL R. GILMORE AND GERALD E. SMITH**  
**APN 08-210-020 and 08-210-021**  
**1 PARCEL RECOGNIZED**

Pursuant to Government Code 66499.34 and 66499.35 the County of Amador Certifies that the following described property complies with the provisions of the Subdivision Map Act and with County Ordinances enacted pursuant thereto.

This certificate relates only to issues of compliance or noncompliance with the Subdivision Map Act and local ordinances enacted pursuant thereto. The parcel described herein may be sold, leased or financed without further compliance with the Subdivision Map Act or any local ordinance enacted pursuant thereto. Development of the parcel may require issuance of a permit or permits, or any other grant or grants of approval.

CONDITIONS OF APPROVAL FOR CERTIFICATE OF COMPLIANCE: NONE  
DESCRIPTION (SEE EXHIBIT "A")

  
\_\_\_\_\_  
CHAIRMAN, BOARD OF SUPERVISORS

**ACKNOWLEDGEMENT**

A **notary** public or other officer completing this certificate verifies only the identity of the individual who signed the document to which this certificate is attached, and not the truthfulness, accuracy, or validity of that document.

State of California )  
 ) SS  
County of Amador )

On Nov. 24, 2015, before me, Teresa Wagstaff, a Deputy Clerk of the Board of Supervisors in and for the County of Amador, State of California, personally appeared **Brian Oneto** who proved to me on the basis of satisfactory evidence to be the person whose name is subscribed to the within instrument and acknowledged to me that he executed the same in his authorized capacity, and that by his signature on the instrument the person, or the entity upon behalf of which the person acted, executed the instrument.

I certify under PENALTY OF PERJURY under the laws of the State of California that the foregoing paragraph is true and correct.

WITNESS my hand and official seal.

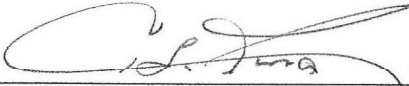
Teresa Wagstaff  
Deputy, Board of Supervisors

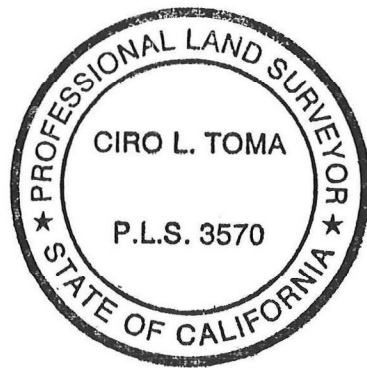


EXHIBIT "A"

**DESCRIPTION FOR GILMORE & SMITH  
Adjusted Parcel D**

A parcel of land situated in the County of Amador, State of California, and being more particularly described as "ADJUSTED PARCEL D 7.50 Acres", as shown and so designated upon that certain official map entitled "RECORD OF SURVEY BOUNDARY LINE ADJUSTMENT for DAVID B. GILMORE and JILL R. GILMORE and GERALD E. SMITH", and filed for record in the office of the Recorder of Amador County in Book 64 of Maps and Plats at Page 47.

 08/13/15  
Ciro L. Toma PLS 3570 License expires 06/30/16



Recording requested by:  
**BOARD OF SUPERVISORS**  
When recorded send to:  
**SURVEYING & ENGINEERING**

---

**CERTIFICATE OF COMPLIANCE**  
**FOR DAVID B. GILMORE, JILL R. GILMORE AND GERALD E. SMITH**  
**APN 08-210-020 and 08-210-021**  
**1 PARCEL RECOGNIZED**

Pursuant to Government Code 66499.34 and 66499.35 the County of Amador Certifies that the following described property complies with the provisions of the Subdivision Map Act and with County Ordinances enacted pursuant thereto.

This certificate relates only to issues of compliance or noncompliance with the Subdivision Map Act and local ordinances enacted pursuant thereto. The parcel described herein may be sold, leased or financed without further compliance with the Subdivision Map Act or any local ordinance enacted pursuant thereto. Development of the parcel may require issuance of a permit or permits, or any other grant or grants of approval.

CONDITIONS OF APPROVAL FOR CERTIFICATE OF COMPLIANCE: NONE  
DESCRIPTION (SEE EXHIBIT "A")

  
\_\_\_\_\_  
CHAIRMAN, BOARD OF SUPERVISORS

**ACKNOWLEDGEMENT**

A **notary** public or other officer completing this certificate verifies only the identity of the individual who signed the document to which this certificate is attached, and not the truthfulness, accuracy, or validity of that document.

State of California )  
 ) SS  
County of Amador )

On Nov. 24, 2015, before me, Teresa Wagstaff, a Deputy Clerk of the Board of Supervisors in and for the County of Amador, State of California, personally appeared **Brian Oneto** who proved to me on the basis of satisfactory evidence to be the person whose name is subscribed to the within instrument and acknowledged to me that he executed the same in his authorized capacity, and that by his signature on the instrument the person, or the entity upon behalf of which the person acted, executed the instrument.

I certify under PENALTY OF PERJURY under the laws of the State of California that the foregoing paragraph is true and correct.

WITNESS my hand and official seal.


Teresa Wagstaff  
Deputy, Board of Supervisors



EXHIBIT "A"

**DESCRIPTION FOR GILMORE & SMITH  
Adjusted Parcel C**

A parcel of land situated in the County of Amador, State of California, and being more particularly described as "ADJUSTED PARCEL C 7.50 Acres", as shown and so designated upon that certain official map entitled "RECORD OF SURVEY BOUNDARY LINE ADJUSTMENT for DAVID B. GILMORE and JILL R. GILMORE and GERALD E. SMITH", and filed for record in the office of the Recorder of Amador County in Book 64 of Maps and Plats at Page 47 .

 08/13/15

Ciro L. Toma PLS 3570 License expires 06/30/16



