

Requested by:
BOARD OF SUPERVISORS
Return to:
SURVEYING & ENGINEERING

**BEFORE THE BOARD OF SUPERVISORS OF THE
COUNTY OF AMADOR, STATE OF CALIFORNIA**

IN THE MATTER OF

RESOLUTION APPROVING ABANDONMENT)
OF A PUBLIC UTILITY EASEMENT FOR) RESOLUTION NO. 13-037
THE REED LEASING GROUP, LLC, A CALIFORNIA)
LIMITED LIABILITY COMPANY)

BE IT RESOLVED by the Board of Supervisors of the County of Amador, State of California that said Board does hereby approve the abandonment of a ten foot (10') wide public utility easement for The Reed Leasing Group, LLC, A California Limited Liability Company, as attached description in Exhibit "A".

The foregoing resolution was duly passed and adopted by the Board of Supervisors of the County of Amador at a regular meeting thereof, held on the 9th day of April, 2013, by the following vote:

AYES: Richard M. Forster, Theodore F. Novelli, Brian Oneto and
John Plasse

NOES: None

ABSENT: Louis D. Boitano



Chairman, Board of Supervisors

ATTEST:

JENNIFER BURNS, Clerk of the
Board of Supervisors, Amador County
California



(RESOLUTION NO. 13-037)

(4/9/13)

OFFICE OF
BOARD OF SUPERVISORS

810 COURT STREET * JACKSON, CA 95642 * (209) 223-6470 * FAX (209) 257-0619



NOTICE OF PUBLIC HEARING

Notice is hereby given that the Board of Supervisors of the County of Amador, State of California, has received a request for an abandonment of a ten foot (10') wide public utility easement and a Certificate of Merger from The Reed Leasing Group, LLC, a California Limited Liability Company. The merger consists of merging Parcel 1 as shown and delineated on the map "Parcel Map No. 2071 for Norman D. Borth, et. ux.," and recorded in Book 38 of Maps and Plats, at pages 73 and 74; and Parcel "B", as shown and delineated on the map "Record of Survey Bamert Property", and recorded in Book 12 of Maps and Plats, at 43, all in the Records of Amador County. The abandonment of the ten foot (10") wide public utility easement is coincident and westerly of the line common with said Parcel 1 and Parcel B. The Property is located on the northerly side of Jackson Valley Road, approximately one-half mile from the westerly junction with State Highway 88, in the Jackson Valley area.

A Public Hearing to consider said abandonment and Certificate of Merger will be held at the County Administration Building, 810 Court Street, Jackson, California 95642, on April 9, 2013, at 10:30 a.m., or as soon thereafter as the matter may be heard, at which time any and all interested persons may come and be heard thereon.

If you have any questions, or desire further information, please contact Surveying & Engineering (209) 223-6371.

*Set 6 FLIERS ON NORTH SIDE OF ROAD
at locations MARKED X*

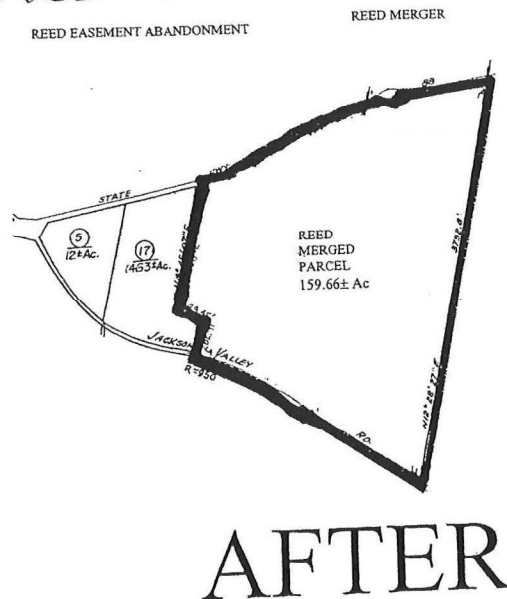

**PUBLIC UTILITY EASEMENT
ABANDONMENT
LEGAL DESCRIPTION
APN: 005-230-016**

All that certain piece or parcel of land situate in the County of Amador, State of California, lying within a portion of the "Rancho Arroyo Seco", described as follows:

ALL that certain Public Utility Easement lying adjacent to and abutting the East line of Parcel 1 as shown and delineated on Parcel Map No. 2071 for Norman D. Borth, et ux, filed in the Office of the County Recorder of Amador County on October 24, 1984 in Book 38 of Maps and Plats, at Page 73.

THE HEREIN ABOVE PUBLIC UTILITY EASEMENT SHALL HEREINAFTER BE CONSIDERED ABANDONED.





Dave Skidmore, L.S. 7126
2/11/13