

Requested By:
BOARD OF SUPERVISORS
When Recorded Return To:
SURVEYING & ENGINEERING

**BEFORE THE BOARD OF SUPERVISORS OF THE
COUNTY OF AMADOR, STATE OF CALIFORNIA**

IN THE MATTER OF

RESOLUTION APPROVING PARCEL MAP NO. 2829) RESOLUTION NO. 11-146
FOR KATHRYN L. MCGHAN, SUCCESSOR)
TRUSTEE OF THE SURVIVOR'S PROPERTY)
TRUST ESTABLISHED UNDER THE MACE FAMILY)
TRUST DATED AUGUST 6, 1993 AND ACCEPTING)
AND REJECTING OFFERS OF DEDICATION)

WHEREAS, the Board of Supervisors of the County of Amador, State of California has determined that said map is in conformity with the requirements of the County of Amador.

THEREFORE, BE IT RESOLVED by the Amador County Board of Supervisors that said Board hereby approves Parcel Map No. 2829 for Kathryn L. McGhan, Successor Trustee of the Survivor's Property Trust established under The Mace Family Trust dated August 6, 1993; and

BE IT RESOLVED by the Board of Supervisors of the County of Amador that all offers of dedication for public utility easements, Lambert Road, and Carbondale Road, appearing on Parcel Map No. 2829, by Ciro L. Toma, Land Surveyor, dated June, 2011, be and hereby are accepted; and

BE IT FURTHER RESOLVED that all others offers of dedication appearing on said map be and hereby are rejected at this time, subject to subsequent acceptance by future resolution of this Board.

The foregoing resolution was duly passed and adopted by the Board of Supervisors of the County of Amador at a regular meeting thereof held on the 6th day of December, 2011, by the following vote:

AYES: John Plasse, Louis D. Boitano, Richard M. Forster, Theodore F. Novelli,
and Brian Oneto

NOES: None

ABSENT: None



Chairman, Board of Supervisors

ATTEST:
JENNIFER BURNS, Clerk of the
Board of Supervisors, Amador County,
California

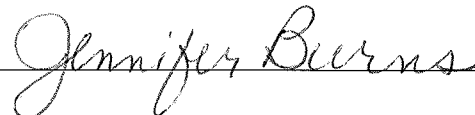

PARCEL MAP No. 2829 PHASE ONE

for
**KATHRYN L. MCGHAN, Successor Trustee of the
 Survivor's Property Trust established under the
 Mace Family Trust dated August 6, 1993**
 2010005663

BEING A DIVISION OF ADJUSTED COMPLIANCE PARCEL 4 PER 58-M-82
 ALSO BEING A PORTION OF THE NW, SW AND SE 1/4 SECTION 21 AND THE
 NE 1/4 SECTION 22, T. 11N., R. 11E., S. 11E.,
 COUNTY OF AMADOR, STATE OF CALIFORNIA.



June, 2011

Scale: 1" = 300'

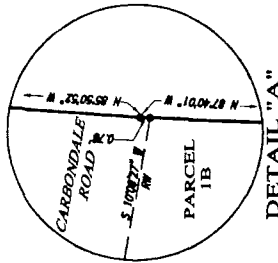

VICINITY MAP
 NOT TO SCALE

CL DATA TABLE
1 (S 30.00' (15.00') (15.00'))
2 (S 30.00' (15.00') (15.00'))
3 (S 30.00' (15.00') (15.00'))
4 (S 30.00' (15.00') (15.00'))
5 (S 30.00' (15.00') (15.00'))
6 (S 30.00' (15.00') (15.00'))
7 (S 30.00' (15.00') (15.00'))
8 (S 30.00' (15.00') (15.00'))

- ### NOTES and LEGEND
- DENOTES 3/4" REBAR WITH PLASTIC CAP STAMPED PLS 3570 SET ON THIS SURVEY
 - DENOTES A CALCULATED POINT ONLY, NOTHING FOUND OR SET
 - DENOTES A FOUND MONUMENT AS NOTED ON PLAT
 - DENOTES PRIVATE DRAINAGE SETBACK
 - DENOTES PUBLIC UTILITY EASEMENT
 - DENOTES BUILDING SETBACK LINE
 - DENOTES CENTERLINE OR DISTANCE TO CENTERLINE
 - DENOTES RIGHT-OF-WAY OR DISTANCE TO RIGHT-OF-WAY
 - DENOTES RECORD DATA PER 48-M-90 AND/OR 58-M-82
 - DENOTES EXISTING OVERHEAD POWER LINES
 - DENOTES 40' (1/2 OF AN 80') RIGHT OF WAY ALONG CARBONDALE ROAD AND 30' (1/2 OF A 60') RIGHT OF WAY ALONG LAMBERT ROAD TO BE DEDICATED TO AMADOR COUNTY

PARCEL 28
 SEE 58-M-71
 TRUMP
 20030018232

PARCEL 29
 DANAMOWER
 20020035359

7-DEEDS-326
 48-M-90
 58-M-82
 PG 8W E
 PG 8W E
 PG 8W E

DETAIL "A"
 NOT TO SCALE

