

**Notice of Preparation of Draft Tribal Environmental Impact Report (TEIR)
Buena Vista Rancheria of Me-Wuk Indians of California
Casino Project, Amador County, California**

To: State Clearinghouse, Office of Planning and Research (15 copies)
P.O. Box 3044, (for delivery, 1400 Tenth Street, Room 222)
Sacramento, California 95812-3044

Amador County Board of Supervisors
(5 copies)
500 Argonaut Lane
Jackson, California 95642

Amador County Planning Department
(1 copy)
Attn: Susan Grijalva, Planning Director
500 Argonaut Lane
Jackson, California 95642

City of Ione (1 copy)
Attention: City Council
P.O. Box 398, (for delivery, 1 East Main Street)
Ione, California 95640

RECEIVED
BD OF SUPERVISORS
2005 JAN 7 PM 4:03
OFFICIAL RECORDS
AMADOR COUNTY, CALIF.

From: The Buena Vista Rancheria of Me-Wuk Indians of California

Subject: Filing of the **Notice of Preparation of a Draft TEIR** in compliance with Section 10.8.2 of the *'Amendment to Tribal-State Compact Between the State of California and the Buena Vista Rancheria of Me-Wuk Indians of California'* ("Compact"). This Notice of Preparation is being circulated only in compliance with Section 10.8.2 of the Compact.

Project Title: Buena Vista Rancheria Casino Project

Lead Government Agency: Buena Vista Rancheria of Me-Wuk Indians of California

Project Location: 4650 Coal Mine Road, Ione, Amador County, California 95640. The casino site is located on a 67-acre parcel in the East ½ of the East ¼ of Section 19, Township 5 North, Range 10 East. APN # 012-100-005. The parcel, commencing at the Northeast corner of Section 19, is 578 feet in width, and 5280 feet in length.

Project Description: The Buena Vista Rancheria of Me-Wuk Indians of California proposes to develop, construct and operate a casino on Tribal lands located near Buena Vista, Amador County, California. The project description, location, and the potential environmental effects are contained in the attached materials.

Action Requested: The Tribal Council of the Buena Vista Rancheria will be the Lead Agency pursuant to the Compact and will cause to be prepared a **Tribal Environmental Impact Report** for the project identified herein.

The Tribe respectfully requests your input, or the views of your agency, as to the scope and content of the environmental information which is relevant to your agency's statutory responsibilities in connection with the approval for the project. Your agency will be requested to utilize the TEIR prepared by the Tribe when considering any permit or entitlement you may issue related to the project. Please provide your comments regarding the off-reservation environmental issues and reasonable mitigation measures that the Tribe will need to have explored in the Draft TEIR.

Due to the time limits mandated by the Compact, your response must be sent at the earliest possible date, but not later than 30 days after the receipt of this notice by the State Clearinghouse and by Amador County.

Please send your response to the following address:

Buena Vista Rancheria of Me-Wuk Indians of California
P. O. Box 162283
Sacramento, CA 95816

Project Title: The Buena Vista Rancheria Casino Project

Project Applicant: The Buena Vista Rancheria of Me-Wuk Indians of California

Date: 1-7-05

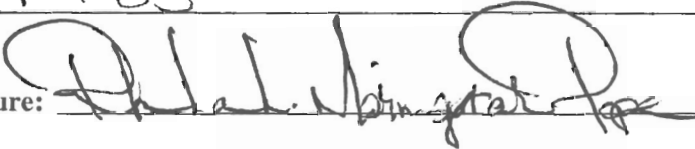
Signature: 

Name: Rhonda L. Morningstar Pope

Title: Tribal Chairperson

Buena Vista Rancheria of Me-Wuk Indians of California
Scope of the TEIR
Amador County, California

The casino will be constructed on an approximately 30 acre site located on Tribal lands at 4650 Coal Mine Road, Ione, Amador County, California.

The Tribal Environmental Review Process

The TEIR will explore the potentially significant off-site impacts of the construction of a multi-level casino offering 56,000 square feet (s.f.) of main gaming floor. The casino will be designed to accommodate approximately 2000 slot machines and 80 gaming tables. Additional casino facilities may include restaurant dining areas, kitchens, retail outlets, lounges, and guest support services. Restaurants may include a buffet, a specialty restaurant, a casual restaurant, a coffee shop, and a food court/fast food area. The casino will offer a ballroom, meeting rooms, administrative offices, and employee services rooms on an upper level. The non-gaming area including all auxiliary services and spaces, combined with the gaming floor, will encompass approximately 400,000 square feet.

The TEIR will also explore the potentially significant off-site impacts of the construction on site of a multi-level parking garage providing 3500 to 4000 parking spaces. A warehouse may also be constructed on site in the lowest levels of the parking structure. Valet parking and employee parking will be provided.

The TEIR will explore a range of options for the provision of potable water and for wastewater treatment services. Potable water tanks and tertiary-treated effluent water tanks will be constructed on site.

The TEIR will explore the possibility of developing wells at the project site, as well as the option of trucking water to the site in the early phases of casino operation. Additional long-term water supply options to be considered include the possibility of construction of an off-site pipeline to utilize water provided by off-site sources.

A tertiary treatment plant meeting standards at least equivalent to California Title 22 will be constructed on-site to treat wastewater. Tertiary-treated effluent waters will be re-used for fire protection water, non-potable domestic water uses, and as landscape irrigation waters. Additional options that the TEIR will consider for tertiary-treated wastewater effluent include the on-site application of the water as crop irrigation water or to subsurface drain fields, the release of water to drainages on-site, and/or the sale of reclaimed tertiary-treated wastewater effluent to off-site users. Off-site wastewater treatment alternatives will be explored.

The TEIR will describe the potentially significant off-reservation environmental impacts to occur as a result of construction and operation of the proposed facility on Tribal lands.

The TEIR will identify ways in which the significant effects on the environment might be minimized and will set forth mitigation measures proposed to minimize significant effects on the environment.

The TEIR will set forth information regarding the feasibility of any proposed mitigation and indicate whether the proposed mitigation would be effective to substantially reduce the significant effects on the environment.

Proposed Baseline Surveys

The following baseline studies are in preparation:

Biological Resources Survey Update
Wetlands and Waters of the U.S. Survey Update
Archaeological Resources Survey Update
Water and Wastewater Feasibility for Proposed Facility
Geotechnical Report for Proposed Facility
Storm Water Analysis for Proposed Facility
Traffic Study Update
Noise Analysis
Air Quality Analysis

Potential Off-Reservation Environmental Effects

Aesthetics

The TEIR will evaluate any aesthetic impacts, including potential impacts on scenic vistas and the possible creation of light or glare impacts. The project is not expected to have any off-reservation impact on scenic resources, because the project is located entirely on Tribal Reservation lands and does not have any physical impact on off-reservation scenic resources.

Agricultural Resources

The TEIR will evaluate the necessity for off-site conversion of farmland to other uses.

Air Quality

The TEIR will evaluate any short-term air quality impacts that may result from fugitive dust and construction vehicle emissions during facility construction. The TEIR will also consider the potential long-term air quality impacts that may result from the increased emissions from the vehicular traffic of facility patrons.

Biological Resources

The TEIR will evaluate any impact to off-site biological resources as a result of the construction and operation of the proposed facility. On-site biological resources will be protected in perpetuity with the implementation of a Tribal Biological Resources Protection Ordinance.

Cultural Resources

The TEIR will evaluate any impact to off-site cultural resources as a result of the construction and operation of the proposed facility. On-site cultural resources will be protected in perpetuity with the implementation of a Tribal Cultural Resources Protection Ordinance.

Geology and Soils

The TEIR will evaluate any impacts to off-site geology and soils resources.

Hazards and Hazardous Materials

The proposed Casino project will not involve the transport, use, or disposal of hazardous materials and/or acutely hazardous materials. The TEIR will include a discussion of aspects of both the project design as well as mitigation measures that will reduce any off-site risk of fire loss.

Water Resources

The TEIR will explore a range of options for the provision of potable water, including the development of wells at the site as well as the option of trucking water to the site in the early phases of casino operation. Additional long-term water supply options to be explored include the construction of an off-site pipeline to utilize water provided by off-site sources.

Wastewater will be treated on-site at a tertiary treatment plant meeting standards at least equivalent to California Title 22. Tertiary-treated effluent waters will be re-used on site for a variety of uses, released to drainages on site, and offered for sale to off-site users. Off-site wastewater treatment alternatives will be explored.

The TEIR will explore any increase in storm-water run-off due to the increase in impervious surface areas to result from the proposed facility, parking garage, and paved roadways.

Land Use

Development of the casino will take place on Tribal lands, which are not subject to state or local jurisdictions. Various off-site construction activities for mitigation may take place on lands that are under the jurisdiction of Amador County and/or the state of California.

Mineral Resources

Construction of any off-site mitigation is not anticipated to cause adverse impacts to the mineral resources in the project area.

Noise

The TEIR will evaluate any short-term off-site noise impacts that may result from facility construction as well as any long-term off-site noise impacts that may result from the facility operations and increased vehicular traffic.

Population and Housing

The project is expected to hire existing local and regional residents rather than to attract new residents, and the project will not result in any off-reservation activity that will displace existing housing.

Public Services

The TEIR will analyze the potential impacts to public services, including the potential for an increase in the demand for fire and police protection.

Recreation

The TEIR will evaluate casino patron usage of existing local recreational facilities, and the extent to which such usage will affect such recreational facilities.

Transportation / Traffic

The TEIR will evaluate 1) short-term low-level impacts to transportation and traffic which may result from facility construction and 2) long-term impacts from traffic increases on State Route 88, Buena Vista Road, Jackson Valley Road, and Coal Mine Road.

Utilities and Service Systems

The TEIR will explore water supply and wastewater options for the proposed project that may include utilization of water from off-site sources. The TEIR will analyze the wastewater treatment options, including the construction of a **tertiary** treatment plant meeting standards at least equivalent to California Title 22. The TEIR will consider the off-site impacts of the provision of electric power and other utilities.

Cumulative Effects

The TEIR will analyze the potentially significant cumulative effects of the proposed project.

Conclusion

Commentors and interested members of the public should note that this TEIR is being prepared pursuant to Section 10.8.2 of the *'Amendment to Tribal-State Compact Between the State of California and the Buena Vista Rancheria of Me-Wuk Indians of California.'*



PROJECT SITE



CONDOR EARTH TECHNOLOGIES, INC.
 21663 Brian Lane
 P.O. Box 3905
 Sonoma, CA 95370
 (209) 532-0361
 fax (209) 532-0773
 www.condorearth.com
 sonora@condorearth.com

CONDOR

Job No.	4469
Date	30 JULY 2004
Scale	AS SHOWN
Drawn	DJT
Chk'd	DL

VICINITY MAP
 PROPOSED CASINO PROJECT
 BUENA VISTA RANCHERIA
 AMADOR COUNTY, CALIFORNIA

FIGURE
1
 File No. 4469F1

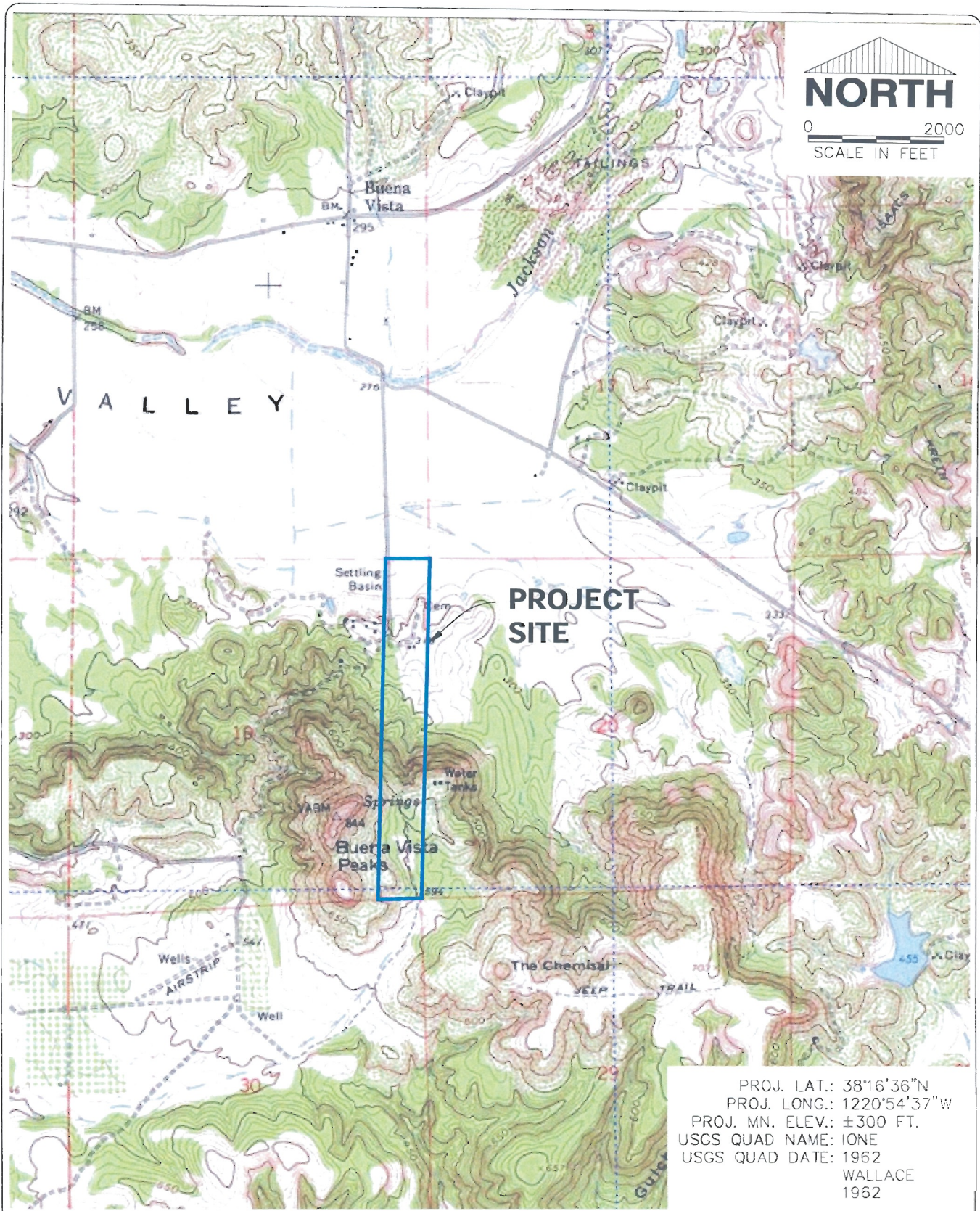

PROJ. LAT.: 38°16'36"N
 PROJ. LONG.: 122°54'37"W
 PROJ. MN. ELEV.: ±300 FT.
 USGS QUAD NAME: IONE
 USGS QUAD DATE: 1962
 WALLACE
 1962



CONDOR EARTH TECHNOLOGIES, INC.
 21663 Brian Lane
 P.O. Box 3905
 Sonora, CA 95370
 (209) 532-0361
 fax (209) 532-0773
 www.condorearth.com
 sonora@condorearth.com

Job No.	4469
Date	30 JULY 2004
Scale	AS SHOWN
Drawn	DJT
Chk'd	DL

SITE MAP
 PROPOSED CASINO PROJECT
 BUENA VISTA RANCHERIA
 AMADOR COUNTY, CALIFORNIA

FIGURE
2
 File No.
 4469F2